

DEVELOPMENT STATISTICS	
Item	Proposed
<b>Site Area</b>	
Block 1	474.10 m <sup>2</sup>
Block 2	1,844.00 m <sup>2</sup>
Block 3	773.17 m <sup>2</sup>
Block 4	5,965.64 m <sup>2</sup>
R.O.W.	2,288.70 m <sup>2</sup>
TOTAL	11,245.61 m <sup>2</sup>
<b>No. of Units</b>	
Block 1	2
Block 2	8
Block 3	7
Block 4	37
TOTAL	54
<b>No. of Parking Spaces</b>	
Block 1	2 per unit (4)
Block 2	2 per unit (16)
Block 3	2 per unit (14)
Block 4	2 per unit (74) + 6 visitor (10 required)

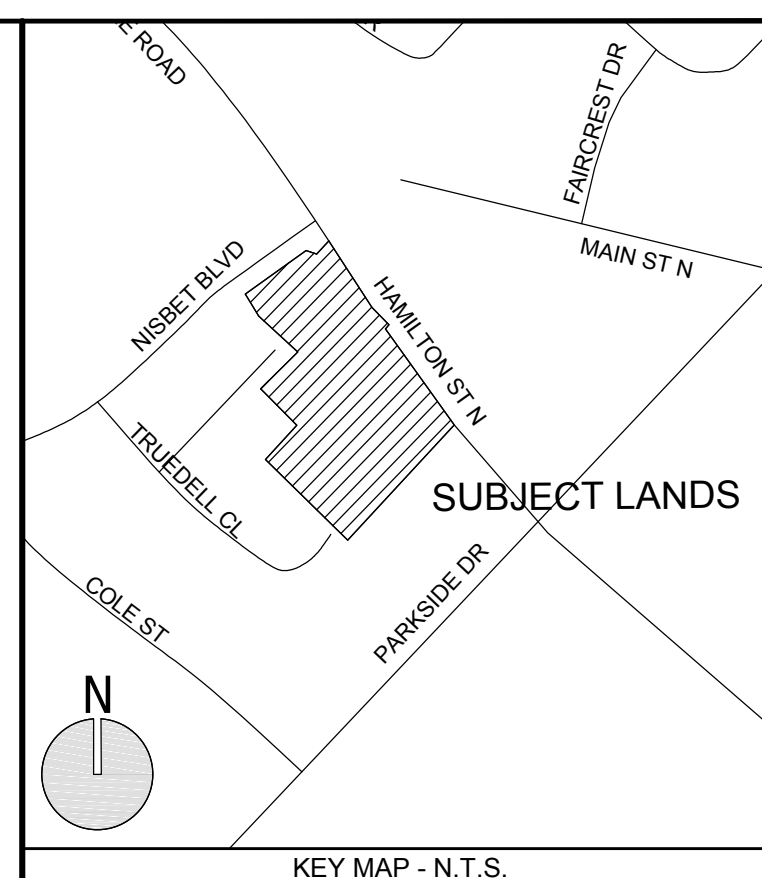

**CONCEPT PLAN**  
**PART OF LOT 8**  
**CONCESSION 4**  
 IN THE FORMER TOWNSHIP OF  
 EAST FLAMBOROUGH  
 NOW IN THE CITY OF HAMILTON

ALL DIMENSIONS SHOWN ON THIS PLAN ARE IN METRES AND CAN BE CONVERTED TO FEET BY DIVIDING BY 0.3048.

SCALE 1:300  
 METRES

LEGEND:

- SUBJECT LANDS
- █ PROPOSED BUILDING

DESIGN BY: S. McKay      CHECKED BY: M. Johnston  
 DRAWN BY: S. McKay      DATE: November 9, 2018

NO.	DATE	BY	DESCRIPTION
1	JAN 19	US	AS PER CLIENT COMMENTS

**NOT FOR CONSTRUCTION**

DRAWING ISSUE RECORD

STAMP

APPROVALS



PROJECT: **Village Center**  
 UHOPA-17-03, ZAC-17-013, 25T-201702  
 609 & 615 Hamilton Street North, 129-137 Truedell Circle and 3 Nisbet Boulevard, Flamborough City of Hamilton

CLIENT: **Parkside Hills Inc.**

US FILE NUMBER: 123-16      SHEET NUMBER: 1

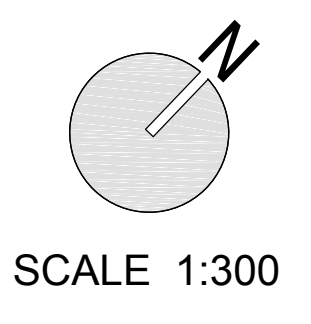

SCALE 1:300